

INSTRUCTION MANUAL

BS03801638

■ Installation Diagram

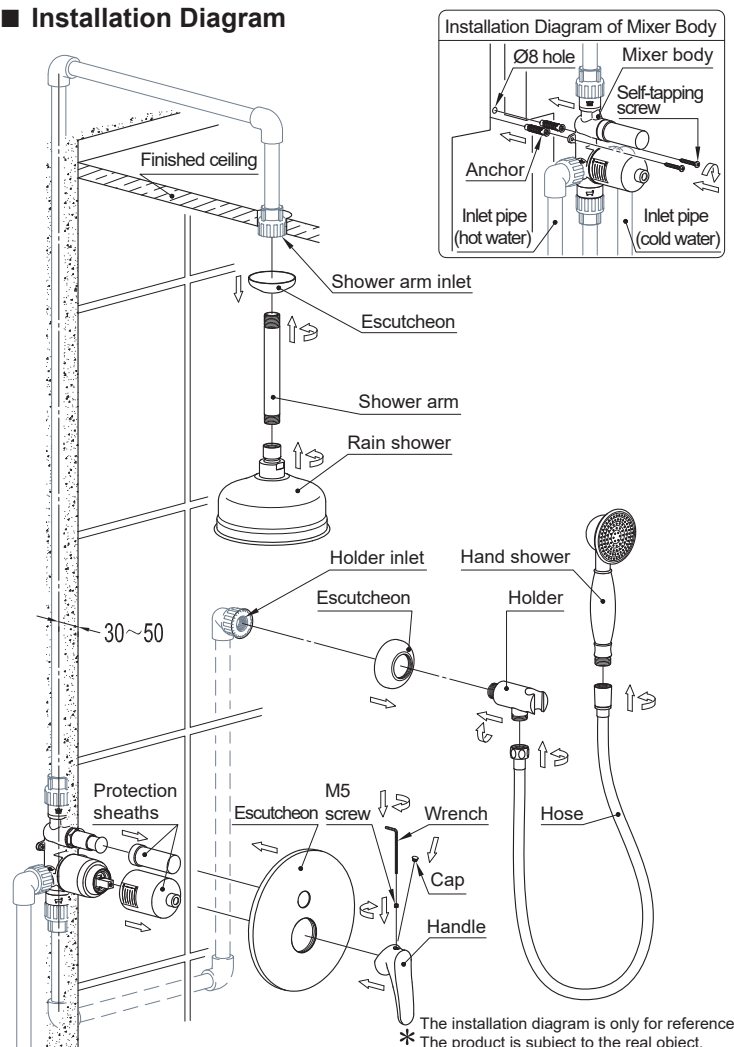

I. Installation Notice

1. Install water pipes in accordance with this manual.
2. Floor drain should be installed onsite.
3. All the components except mixer body should be installed only after the completion of house interior decoration in case paint or other chemicals erode the mixer surface.
4. Run water to clean pipes so as to get rid of mud, sand or other debris blocked in pipes before installation.
5. If the thread does not match well with the water pipe, please identify the cause first; otherwise a forced connection will damage the product.
6. After installation, check all the joints to ensure they are firmly connected. Turn on and off the water repeatedly to ensure there is no leakage around the joints. After that, the product is ready for normal use.
7. Keep the manual to users.

II. Operation Notice

1. The product is used at water pressure 0.05~1.0MPa and water temperature 4~90°C.
2. Do not place heavy objects on the mixer.
3. Make sure the faucet is off when no water comes out of it, especially when nobody resides in or during the period of decoration or suspension of water.
4. Regularly clean the surface of product to keep it bright. Attention: Do not use inappropriate tools such as sharp brushes, rough sponges, scouring pads or corrosive detergent to clean the product. It is not recommended to use the detergent sold in the market, because its formula changes frequently. Please clean the product with wet cloth and soapy water after usage. Then rinse the soap off with clean water and dry with a soft cotton cloth.
5. When room temperature falls below 0°C, take necessary measures (keep the product warm, close windows) to prevent the product from frost cracking, especially when windows open for air ventilation while nobody in the house.
6. Turn on the cold water first, then hot water. Adjust the temperature before use to avoid scald.
7. Do not disassemble the product without help from the professionals.

■ Installation Steps

1. Connect the inlet and outlet pipes as shown in the diagram. Drill two Ø8 holes in the wall and fix the mixer body to the wall by anchors and self-tapping screws. Attention: The threads on the connections of water pipes and mixer body should be wrapped with teflon tape. Flow water to get rid of the debris in pipes before connecting the mixer body. The distance from pipe center to the finished wall is 30-50mm and the inlet pipes must be connected for hot left and cold right.
2. Remove the protection sheath and turn off the cartridge, test the connecting parts of inlet pipes at water pressure 1.6MPa. Plug the outlets and turn on the cartridge, test the connecting parts of outlet pipes at water pressure 0.4MPa. Then put back the protection sheath if there is no leakage. Note: This product has an in-wall valve body, so before tiling, run water to perform pressurized test and make sure no leakage after connecting pipes.
3. Install ceiling and ceramic tiles (make sure to put on the protection sheath).
4. Pass the escutcheon through the shower arm. The shower arm with longer thread should be wrapped with teflon tape to connect the shower arm inlet.
5. Install the rain shower onto the shower arm. Make sure that they are firmly tightened to avoid falling during usage.
6. Pass the escutcheon through the holder. Wrap the inlet thread of the holder with teflon tape to connect the holder inlet.
7. Connect hand shower to holder with hose. Then insert the hand shower into its holder.
8. Take off the protection sheath and put on the escutcheon. Install the handle and tighten with M5 screw. Then put back the cap.
9. When completed, run water to test whether the installation is proper.