

INSTRUCTION
MANUAL

BS03951736

I. Installation Notice

1. Please lay water pipes in accordance with this manual.
2. Floor drain should be installed on the site.
3. Shower head except shower holder should be installed only after the completion of house interior decoration in case paint or other chemicals erode the mixer surface. Before this, please keep the protection sheath on the shower base.
4. Clean pipes to get rid of mud, sand or other debris blocked in pipes before installation.
5. Check whether the threads can be matched. Otherwise, install forcefull will damage the components.
6. After installation, check all the joints to make sure they are firmly connected. Then keep water flow. Turn on and off repeatedly to ensure no leaking problem. After that, the product is ready for normal use.
7. Hand the manual to users.

II. Operation Notice

1. The product is used under water pressure 0.2~0.5 MPa, water temperature 4~70°C.
2. Do not hang heavy things on the product.
3. Remember to turn off the mixer if no water comes out of it (Especially when nobody in the house or during the decoration period).
4. Clean the surface of the product regularly to keep it glossy. Note: Please do not use inappropriate tools such as sharp brushes, rough sponges, scouring pads or corrosive detergent. And it is not recommend to use the detergent sold in the market, because its formula changes frequently. Please clean the product with wet cloth and soapy water after usage. Then rinse the soap off with clean water and dry with a soft cotton cloth.
5. Adjust the temperature before use to avoid scald.
6. Do not disassemble the product without help from the professionals.

III. Installation Diagram

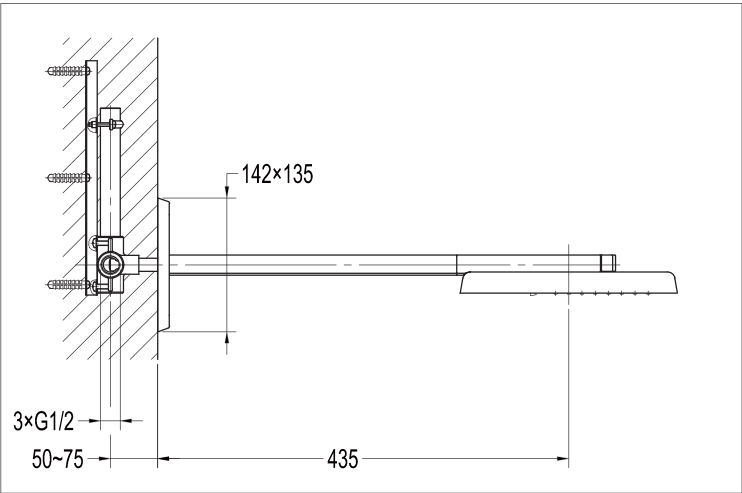

IV. Installation Steps(Fig.1-19) : * The installation diagram is only for reference. The product is subject to the real object.

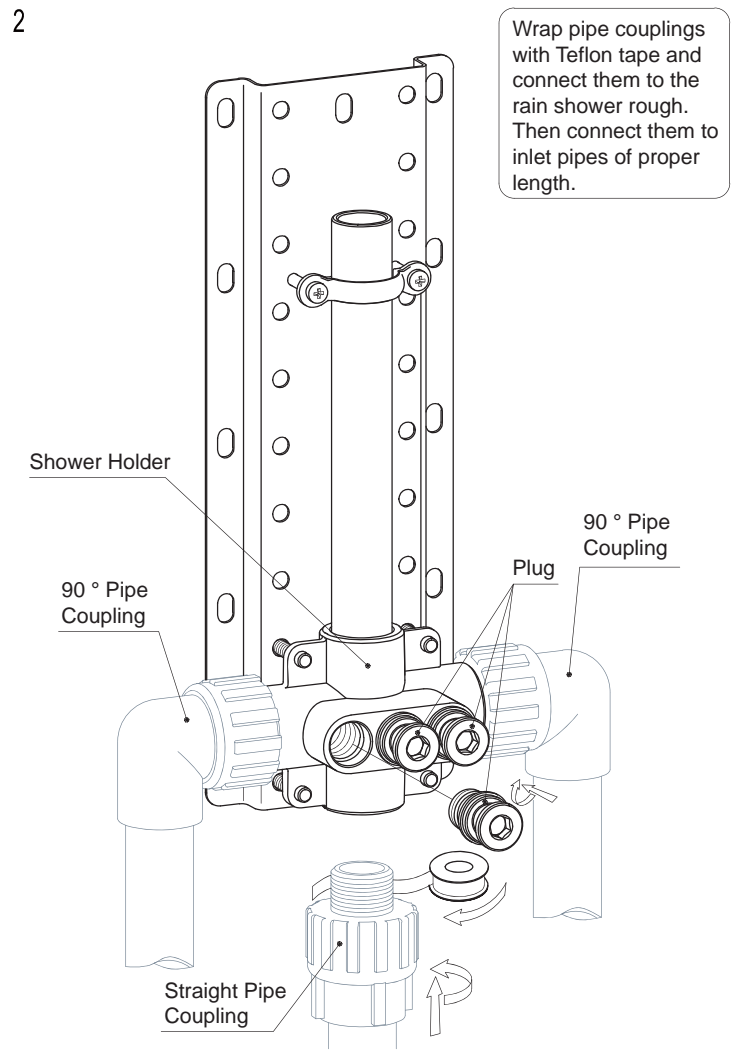
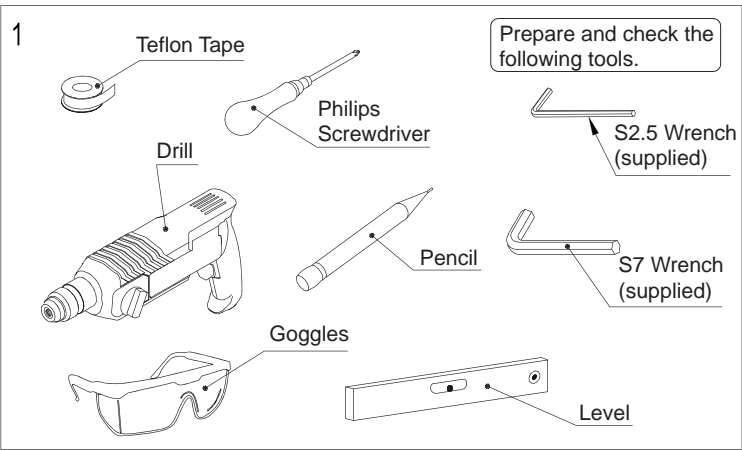

3

Mounting
Plate

Take the six holes on the mounting plate as benchmark to mark positions on walls. Adjust positions by a level.

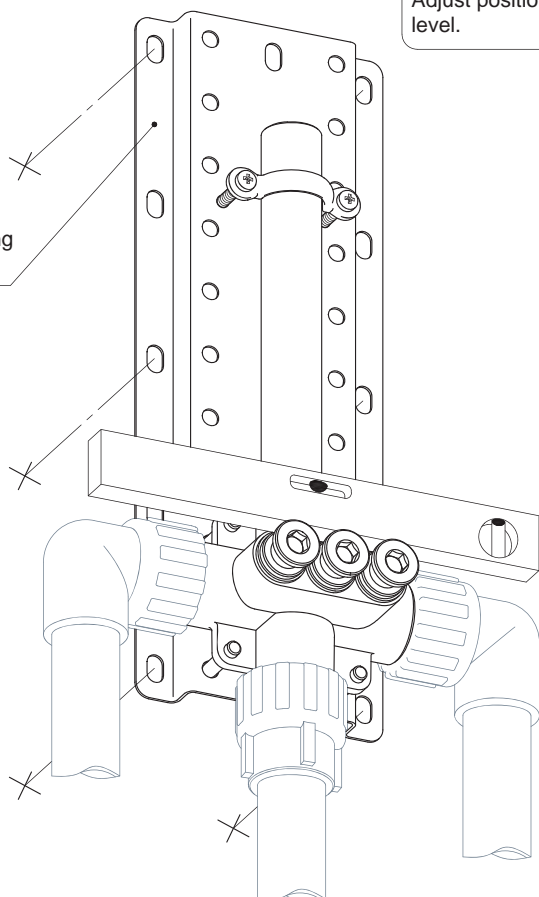

6

Lightly fix the shower holder with self-tapping screws.

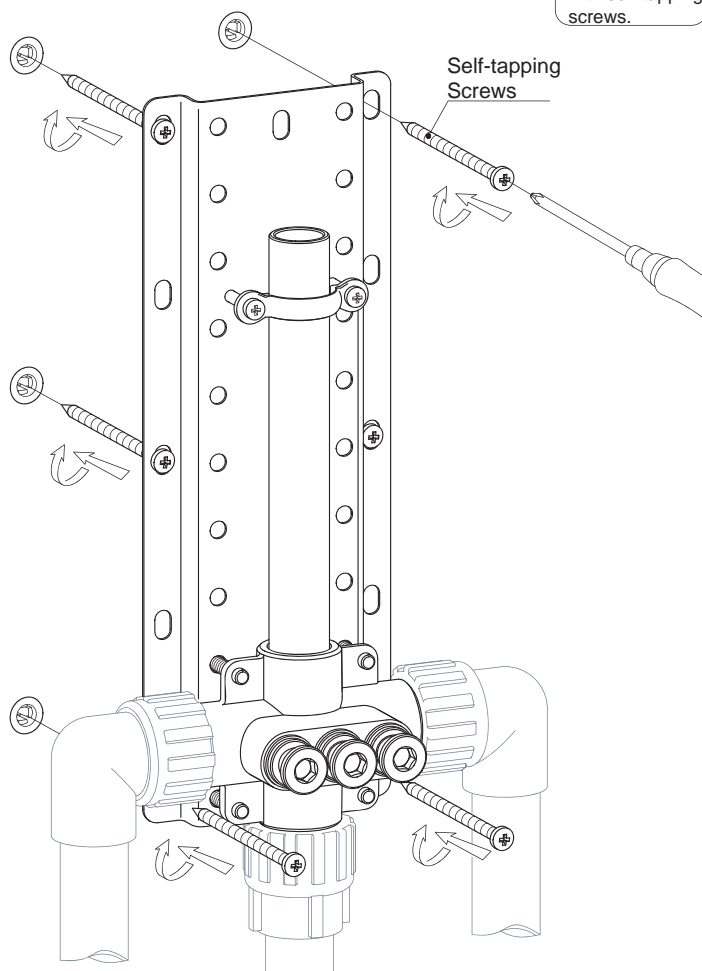
Self-tapping
Screws

4

Drill holes.

4 x Ø8 holes

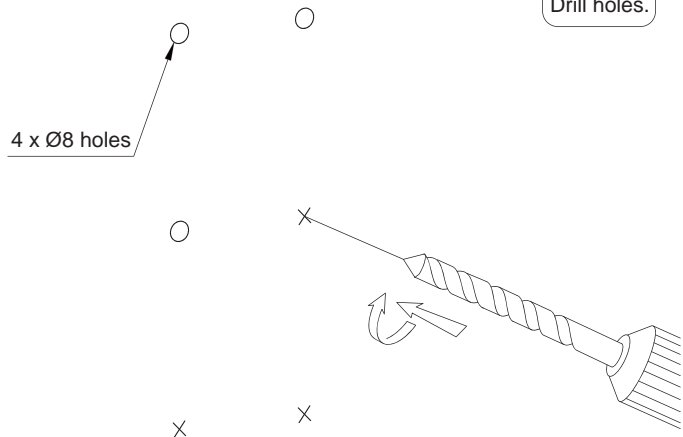

5

Insert anchors.

Anchor

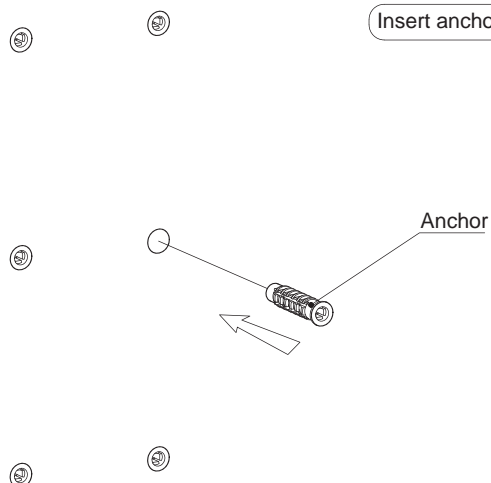

7

Adjust positions by a level and tighten self-tapping screws.

Adjust horizontal level

Adjust vertical level

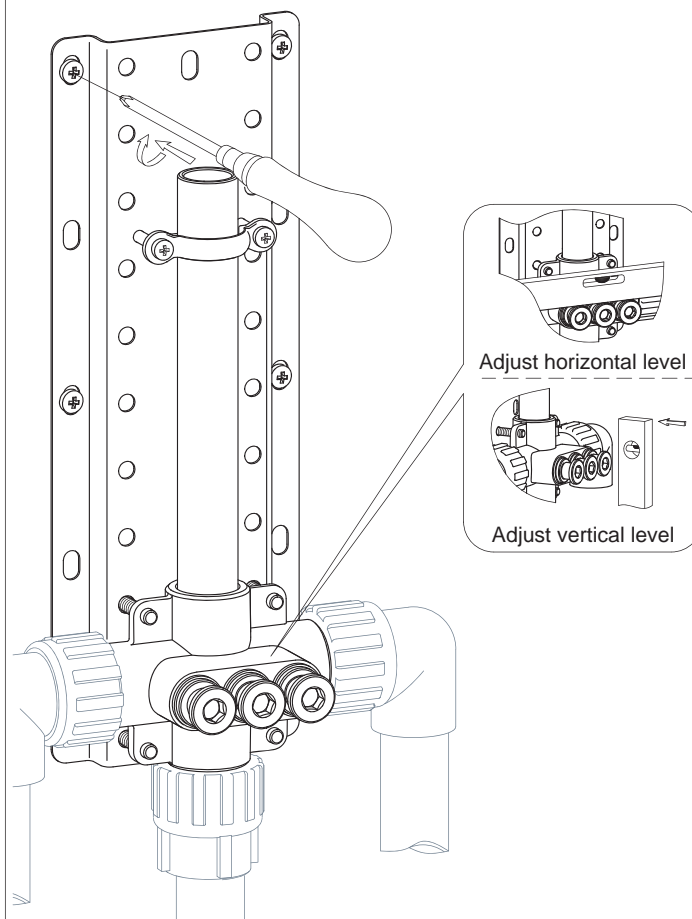

8

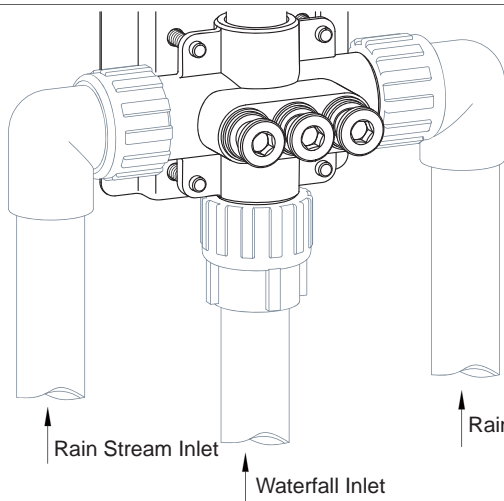

Connect pipes for pressure test. Check all joints to avoid leakage.



Rain Shower Inlet

Waterfall Inlet

Rain Stream Inlet

12

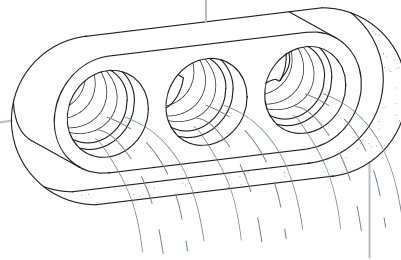

Flow water to get rid of dirt in pipes.

9

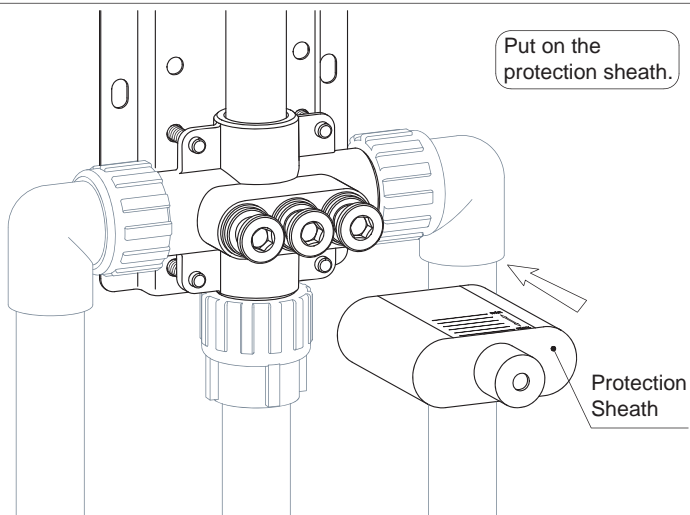

Put on the protection sheath.

Protection Sheath

13

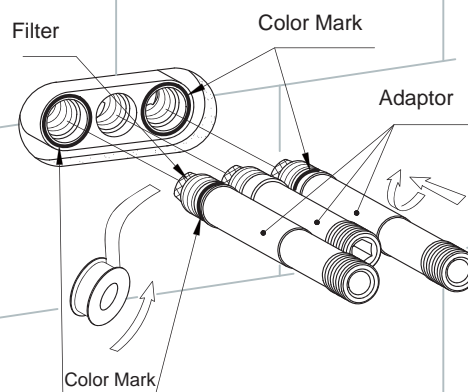

Wrap the adapters with Teflon Tap. Pay attention to the position relevance and install the adapters per the color marks. Please be noted that there are filter nets in the adapters.

10

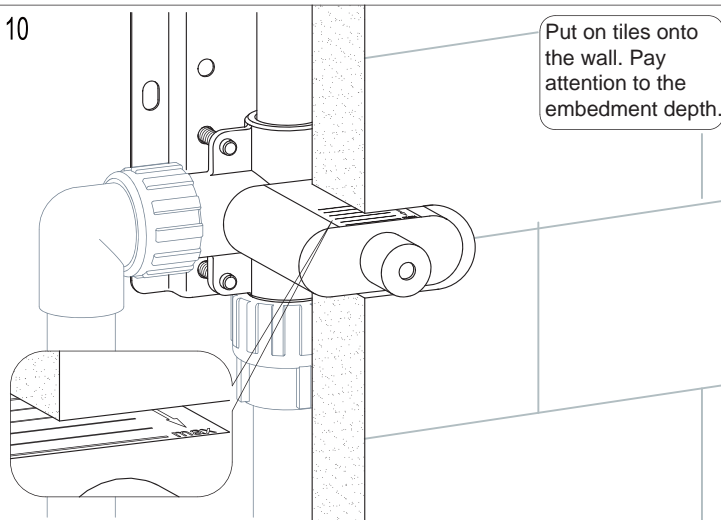

Put on tiles onto the wall. Pay attention to the embedment depth.

14

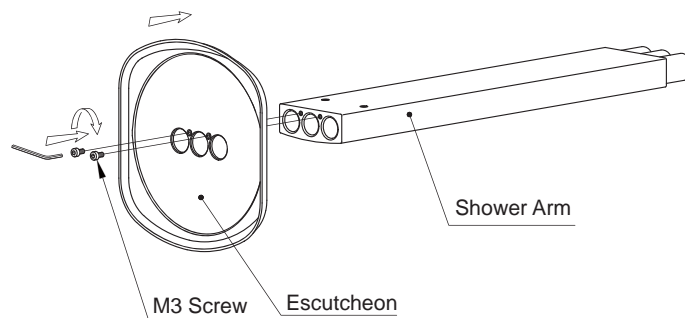

Install the escutcheon to the shower arm.

Shower Arm

M3 Screw

Escutcheon

11

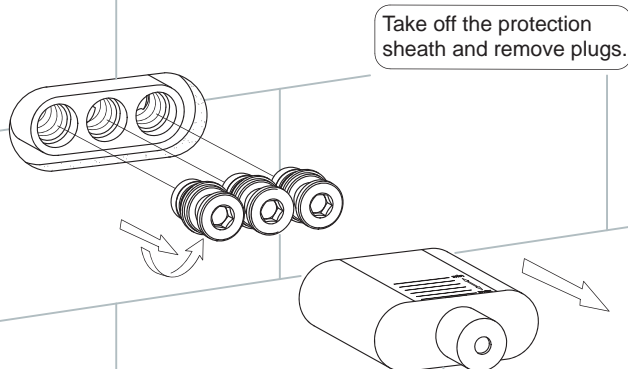

Take off the protection sheath and remove plugs.

15

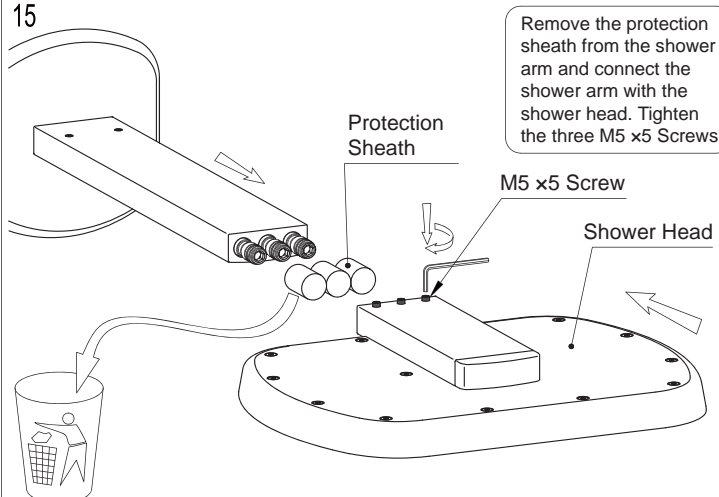

Remove the protection sheath from the shower arm and connect the shower arm with the shower head. Tighten the three M5 x5 Screws

Protection Sheath

M5 x5 Screw

Shower Head

16

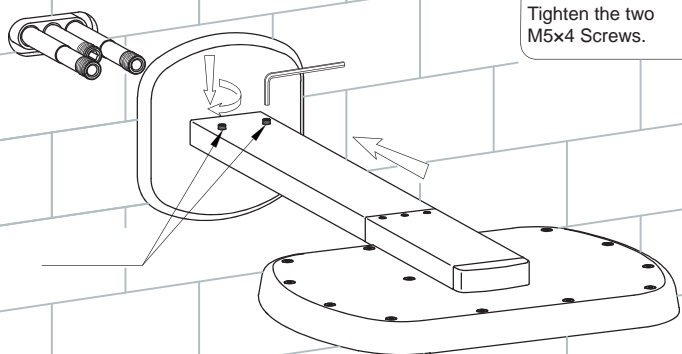

Install the shower head to the adaptors close to the wall. Tighten the two M5x4 Screws.

17

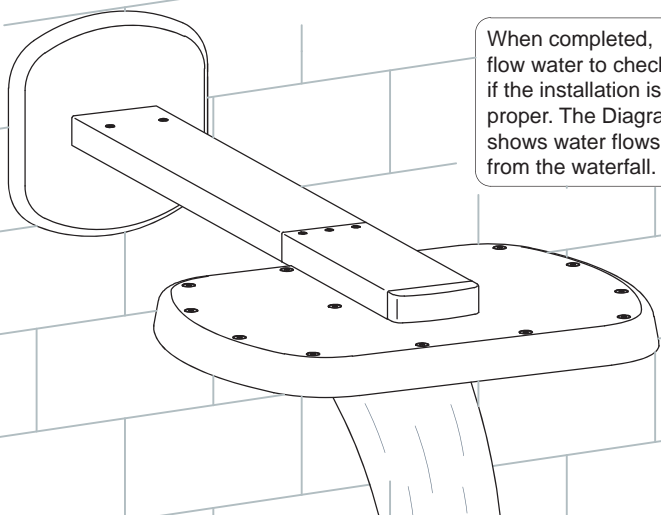

When completed, flow water to check if the installation is proper. The Diagram shows water flows from the waterfall.

18

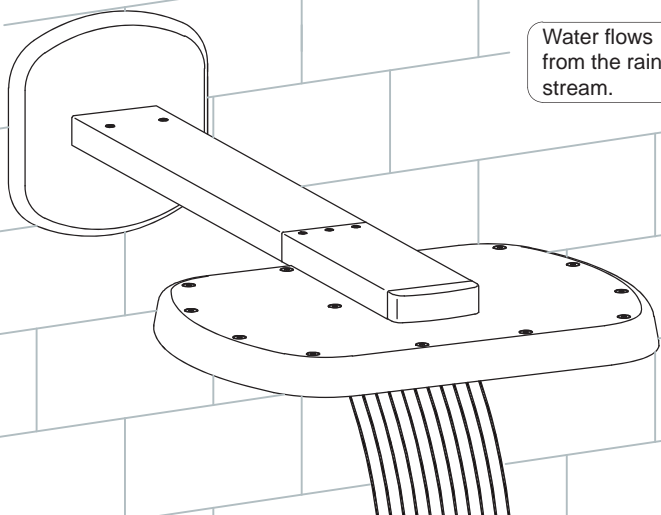

Water flows from the rain stream.

19

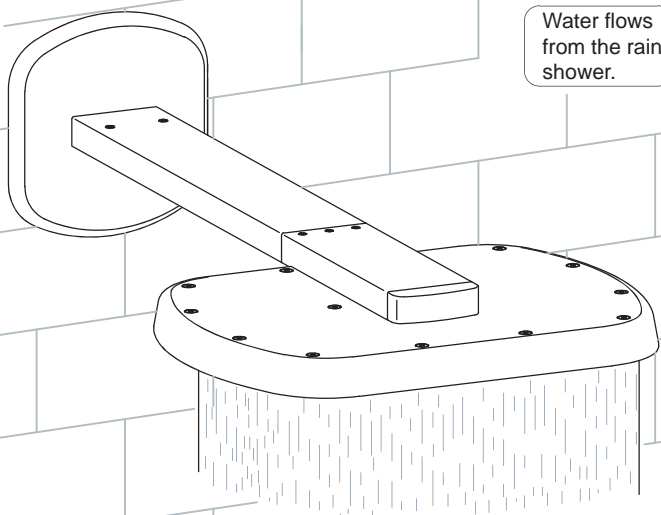

Water flows from the rain shower.

V. Maintenance (Diagram 20-23):

If flow rate is lessened after a period of usage, it is possibly because debris blocks the filters due to poor water quality. Cleaning method should be taken as shown in Diagram 20-23. Then reinstall as Diagram 13 and Diagram 16. If water flow from the rainshower becomes lessened or does not spray evenly, it might be due to debris blocking the outlet. Gently squeeze those rubber outlets on the rainshower with fingers as shown in Diagram 23. Then wash debris out with running water.

20

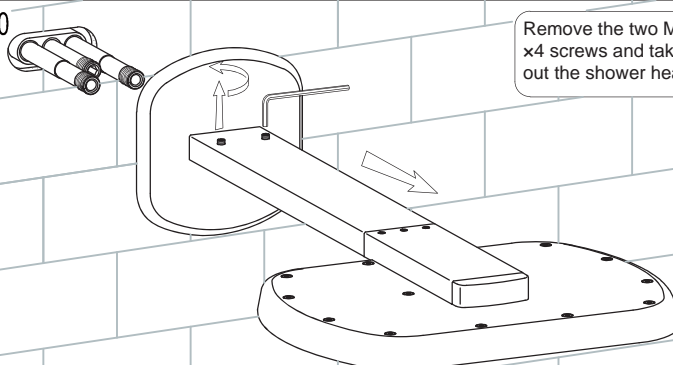

Remove the two M5 x4 screws and take out the shower head.

21

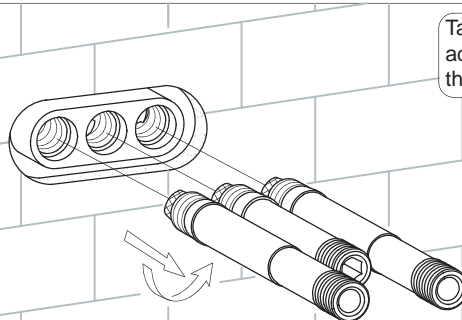

Take off the adaptors and clean the filter nets.

22

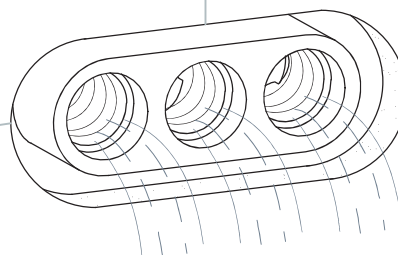

Run water to get rid of debris inside the pipes.

23

