

INSTRUCTION MANUAL

BS81192119

I. Installation Notice

1. Install water pipes in accordance with this manual. Floor drain should be installed on the site.
2. All the components except mixer body should be installed only after the completion of house interior decoration in case paint or other chemicals erode the mixer surface.
3. Run water to clean pipes so as to get rid of mud, sand or other debris blocked in pipes before installation.
4. If the thread does not match well with the water pipe, please find out the reason first; otherwise a forced connection will damage the product.
5. After installation, check all the joints to ensure they are firmly connected. Turn on and off the water repeatedly to ensure there is no leakage around the joints. After that, the product is ready for normal use.
6. Keep the manual to users.

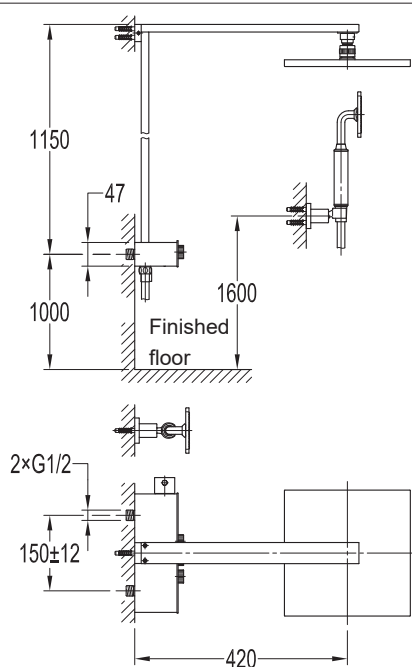

III. Operation Notice

1. The product is used under cold water temperature 4~29°C, hot water temperature 45~85°C and water pressure 0.05~1.0 MPa. Please avoid large pressure difference between hot and cold water. The thermostatic cartridge is preferably in use under the condition of water pressure 0.3 MPa, cold water 15°C, hot water 65°C. Main valve should be equipped with a filter.
2. To avoid using the faucet as hand rail, a separate hand rail must be installed if needed. Also, do not hang heavy objects on the mixer.
3. Make sure the faucet is off when no water comes out of it, especially when nobody resides in or during the period of decoration or suspension of water.
4. Regularly clean the surface of faucet to keep it bright. Attention: Do not use inappropriate tools such as sharp brushes, rough sponges, scouring pads or corrosive detergent to clean the faucet. It is not recommended to use the detergent sold in the market, because its formula changes frequently. Please clean the faucet with wet cloth and soapy water after usage. Then rinse the soap off with clean water and dry with a soft cotton cloth.
5. Residues of shampoo, shower gel, hair dye, perfume, shaving water, nail polish, toothpaste and other substances may cause damage to the product. Please carefully rinse residues with clean water after use. Also, do not store detergents and chemicals under the product, such place as vanity cabinet of washbasin; otherwise volatile gases will damage the product.
6. When room temperature falls below 0°C, take necessary measures (keep the product warm, close windows) to prevent the product from frost cracking (especially when windows open for air ventilation while nobody in the house).
7. Turn on the cold water first, then hot water. Adjust the temperature before use to avoid scald.
8. Sensitive parts of the body, such as eyes, must be kept out of water flows from shower head and sufficient distance between shower head and human head is needed.
9. Children, adults with mental disorders should not be allowed to use the shower system without supervision, nor should people affected by alcohol or drugs.
10. Do not disassemble the product without help from the professionals.

IV. Installation Steps(Fig.1-23): *

The installation diagram is only for reference. The product is subject to the real object.

1

Prepare and check the following tools.

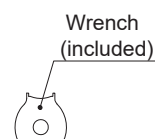
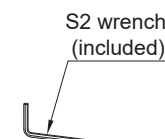
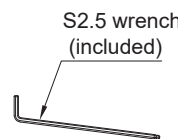
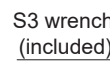
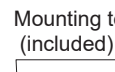
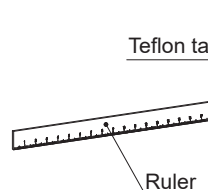
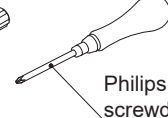
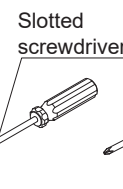
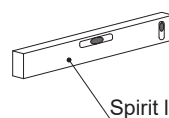
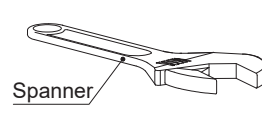
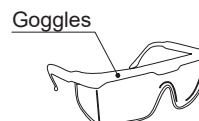
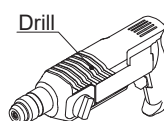

2

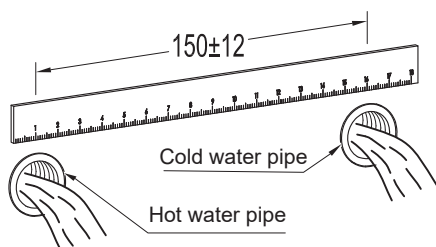

In the wall about 1000mm above the floor, install hot and cold pipes with the distance 150mm in between. Please note that the inlets must be connected for hot left and cold right. Otherwise thermostatic cartridge will malfunction, or even cause scalding. Drill the smallest possible holes on the tile with maximum $\Phi 42$ mm diameter. Run water to get rid of the debris in pipes.

3

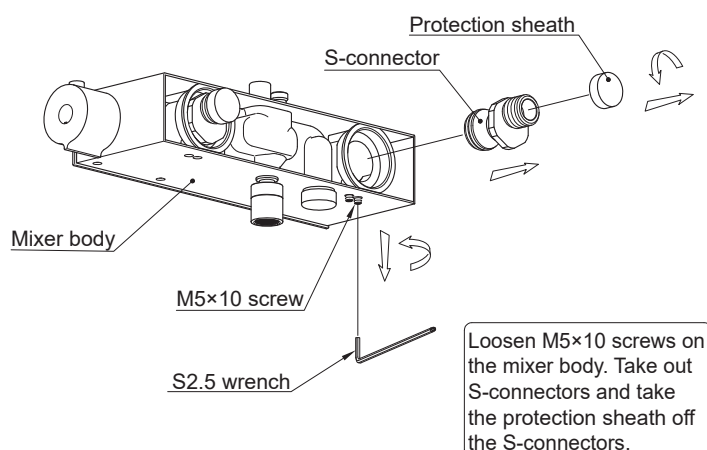

6

Install mixer body onto the S-connectors and place it against wall. Make sure not to expose holes drilled on the ceramic tile (Otherwise adjust the S-connectors again), then tighten with four M5×10 screws.

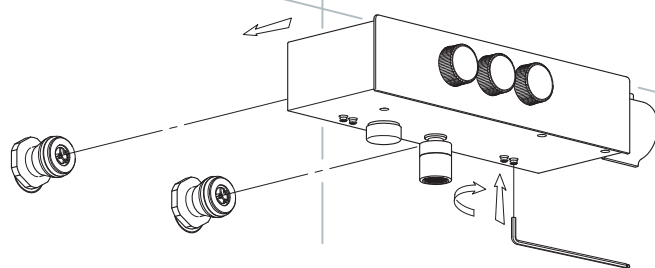

7

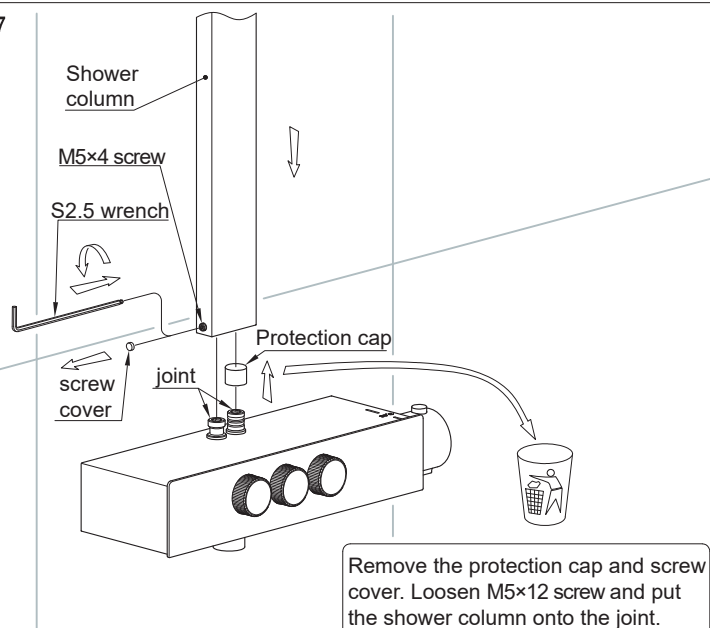

4

Place the hexagon end of S-connectors against the wall.

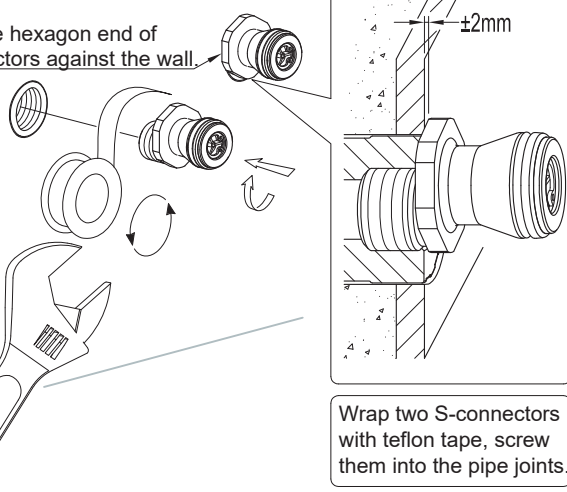

8

Adjust the shower column to the vertical position with a spirit level. Take the outer contour of mounting piece as benchmark to mark lines on the wall. Then take off the shower column.

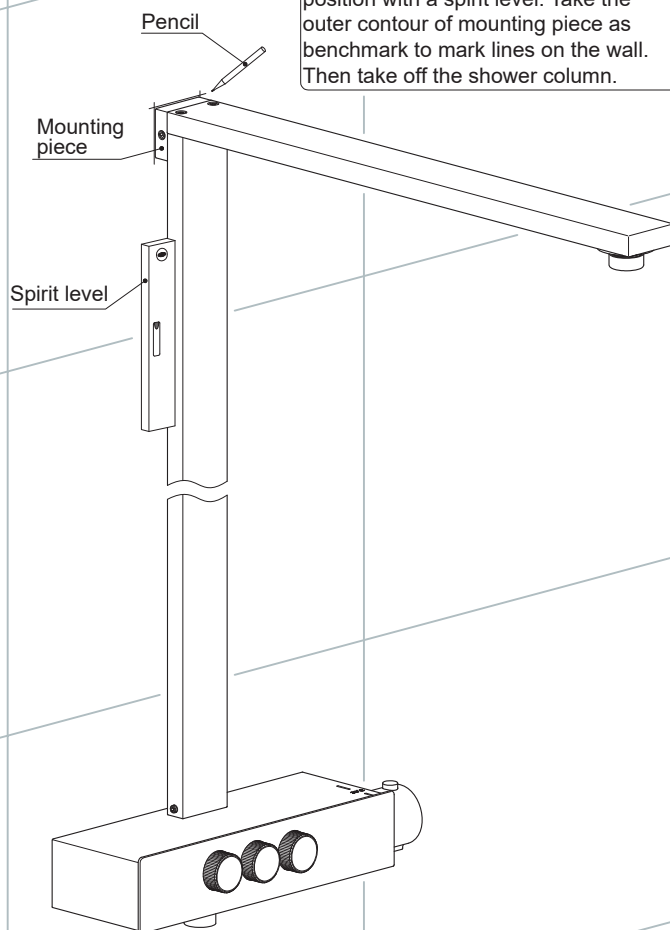

5

Mounting template

Spirit level facing outside (bubble in the middle)

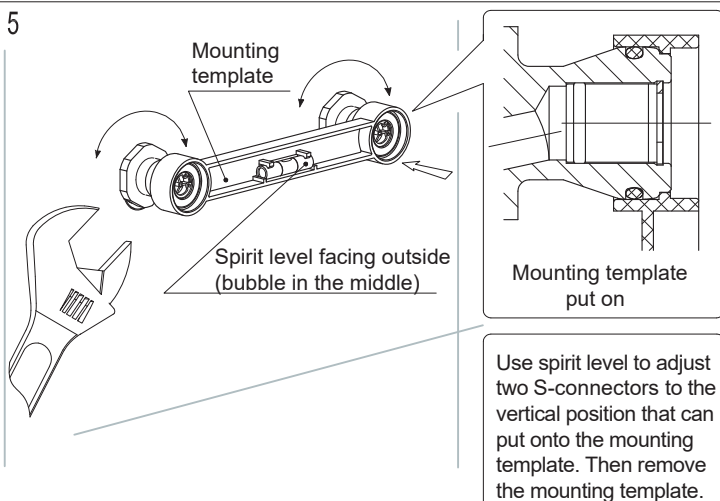

9

Loosen M6 screws, and take the mounting piece off the shower column.

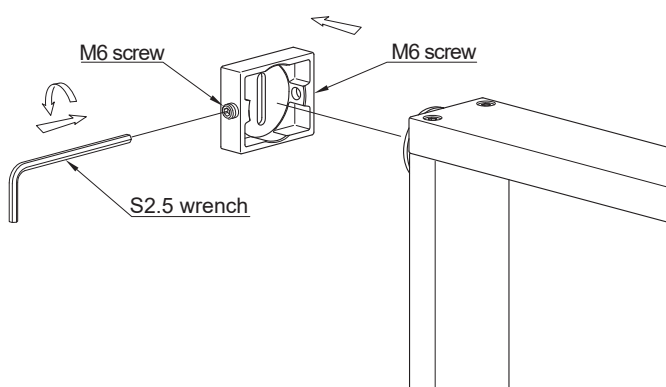

12

Use self-tapping screws to fix the mounting piece to the wall.

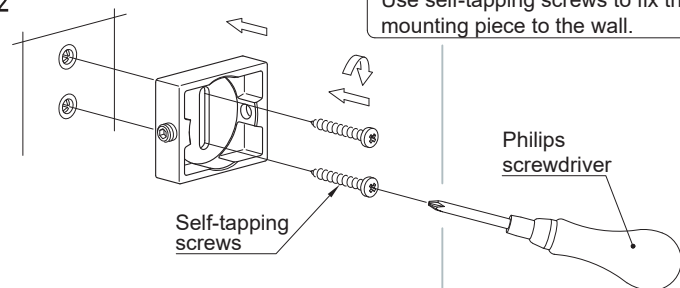

10

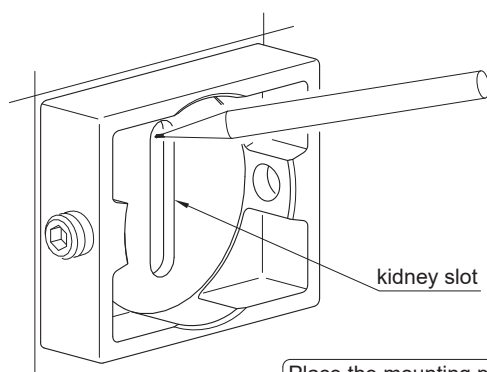

Place the mounting piece on the marked lines. Take the kidney slots as benchmark to mark lines on the wall.

13

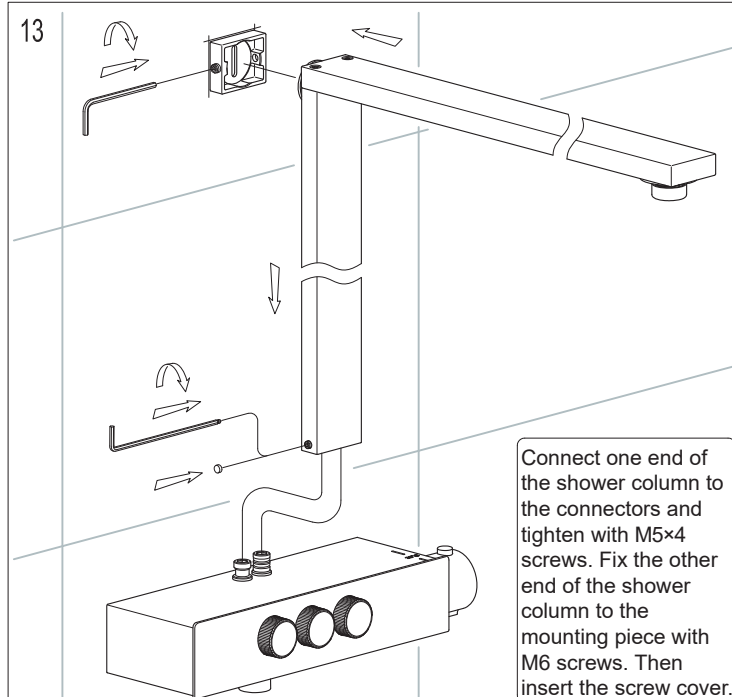

Connect one end of the shower column to the connectors and tighten with M5x4 screws. Fix the other end of the shower column to the mounting piece with M6 screws. Then insert the screw cover.

11

To prevent sand or other debris from falling onto the product during drilling, please cover the mixer body with a cloth bag. Drill two Ø8 holes on the marked lines. Then insert the anchors.

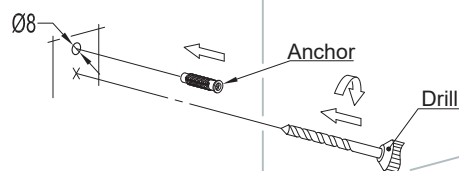

14

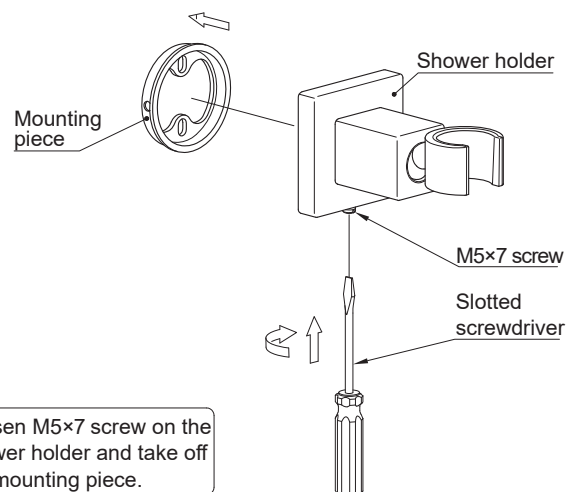

Loosen M5x7 screw on the shower holder and take off the mounting piece.

15

Place the mounting piece vertically at a suitable height on the wall. Take the kidney slots on the mounting pieces as benchmark to mark lines on the wall.

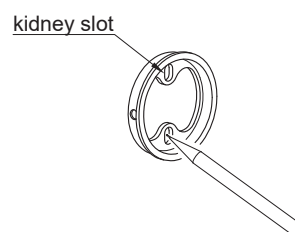

16

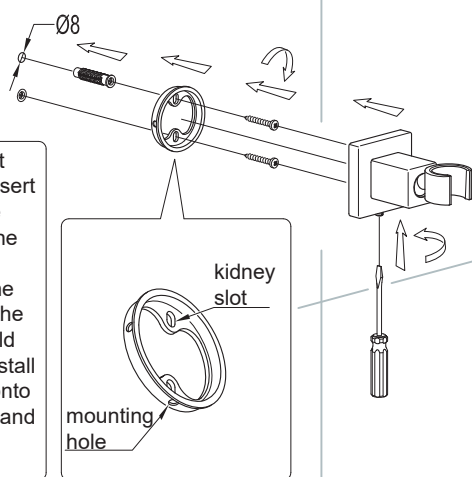

17

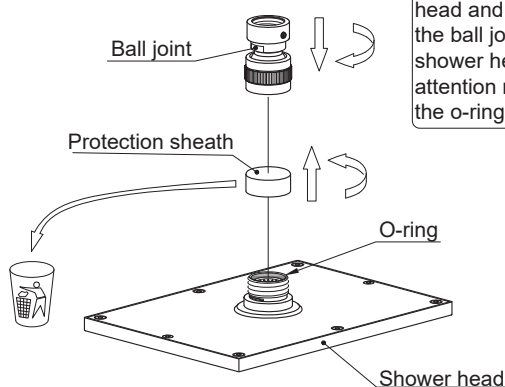

Take the protection sheath off the shower head and tightly install the ball joint onto the shower head. Pay attention not to dropping the o-ring.

20

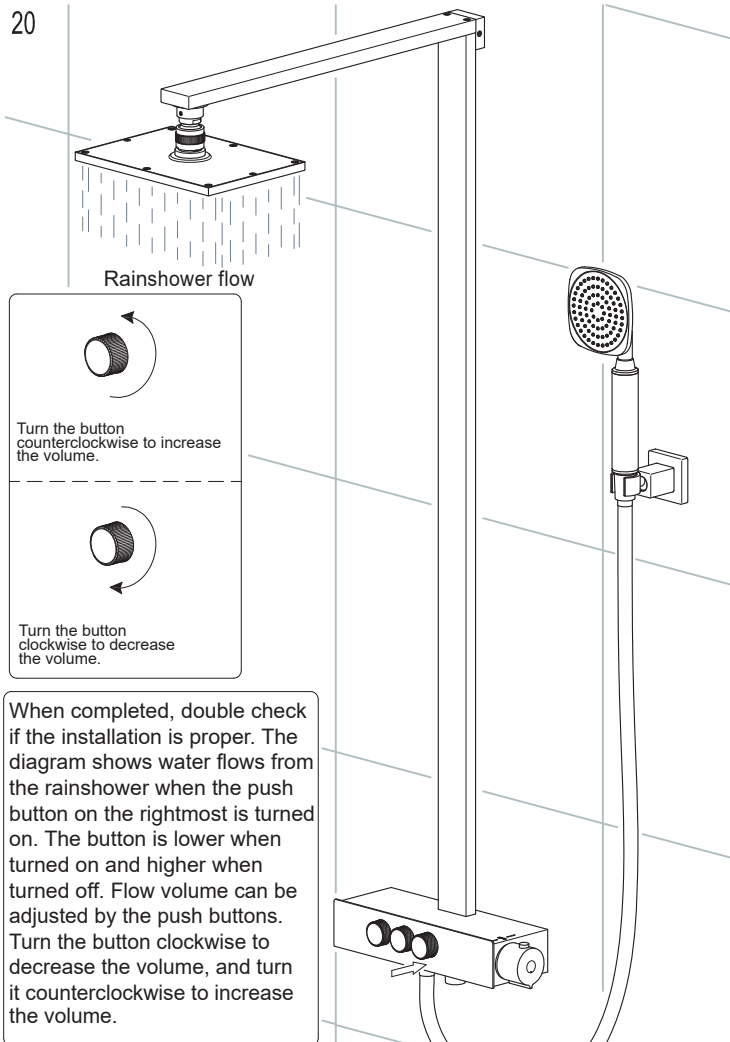

18

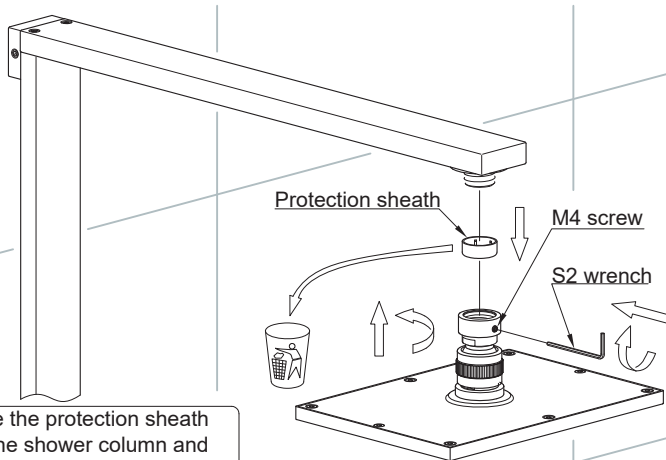

Take the protection sheath off the shower column and screw shower head onto it. Then tighten with M4 screws.

19. Take the protection sheath off the mixer body. Connect handshower to mixer body with hose and insert the handshower into its holder.

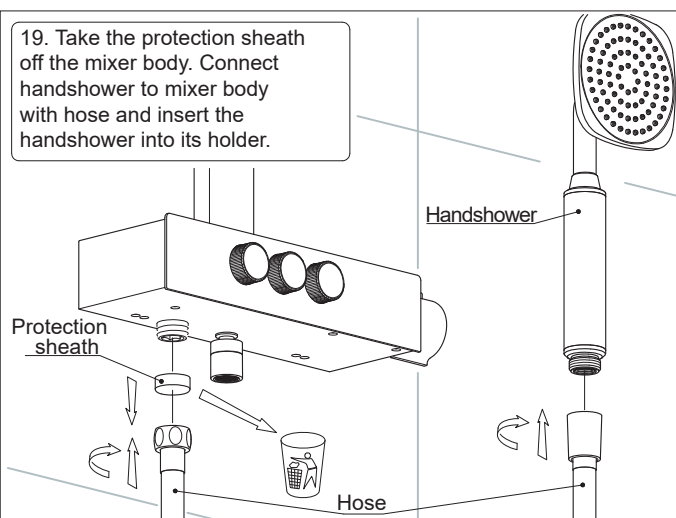

21

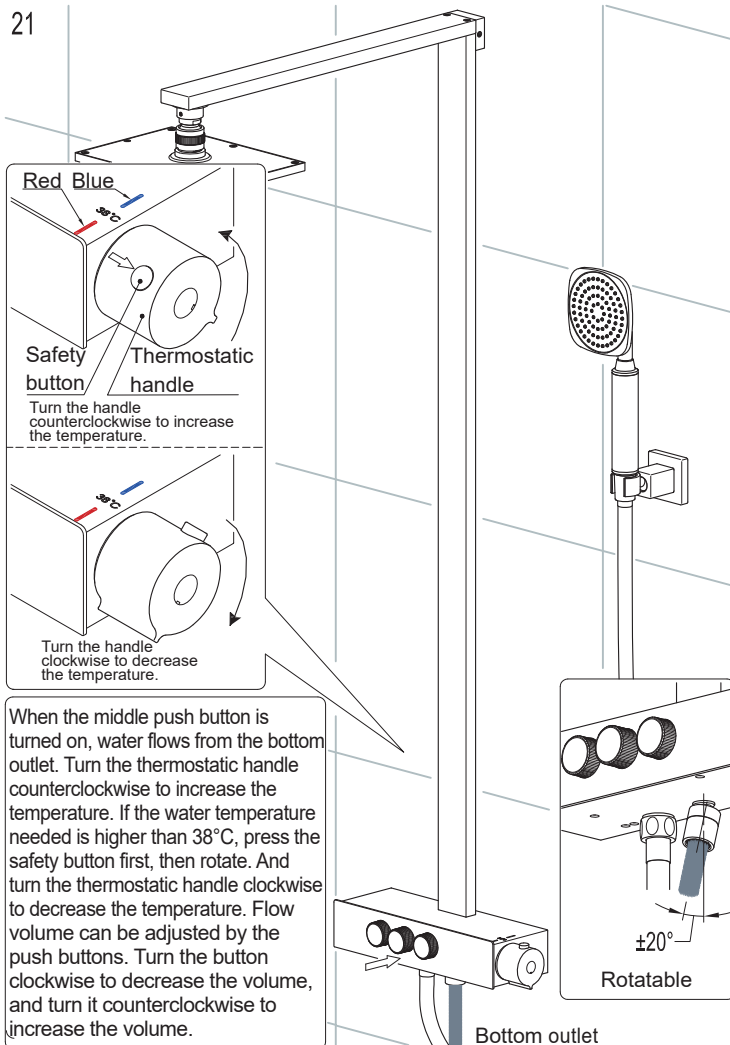

22

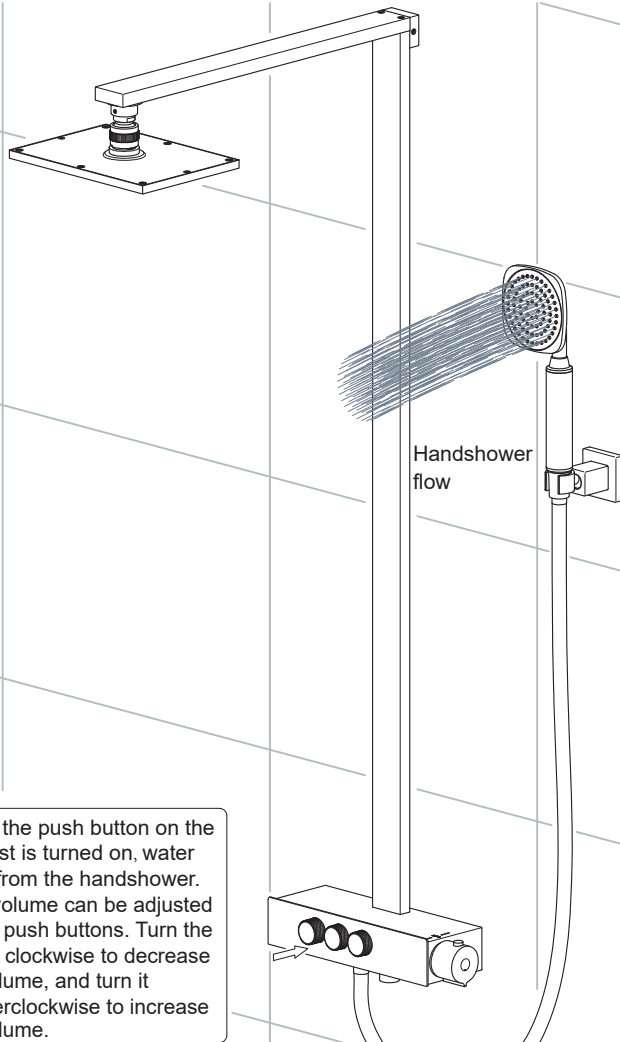

23

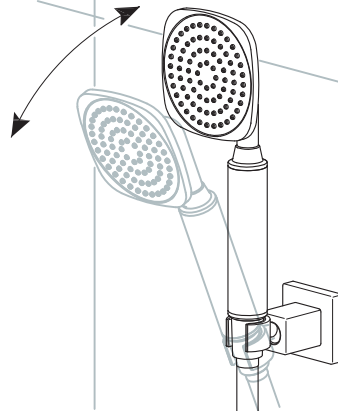

24

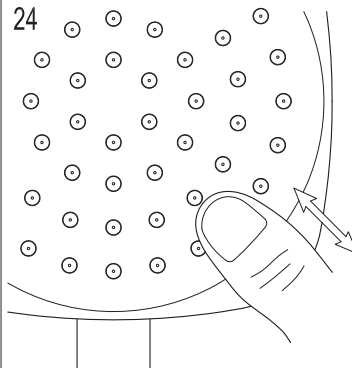

25

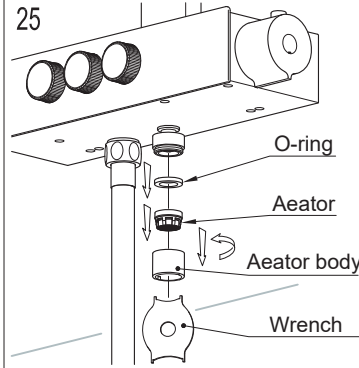

26

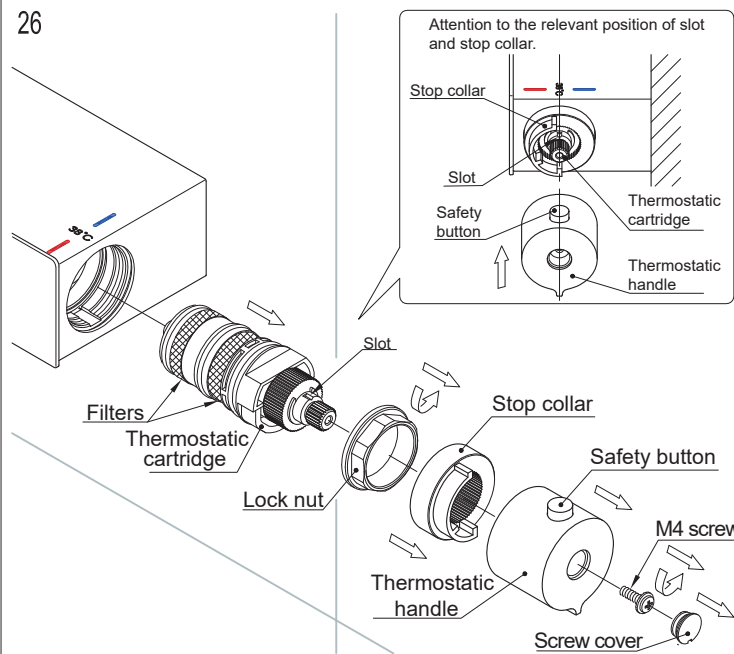

27

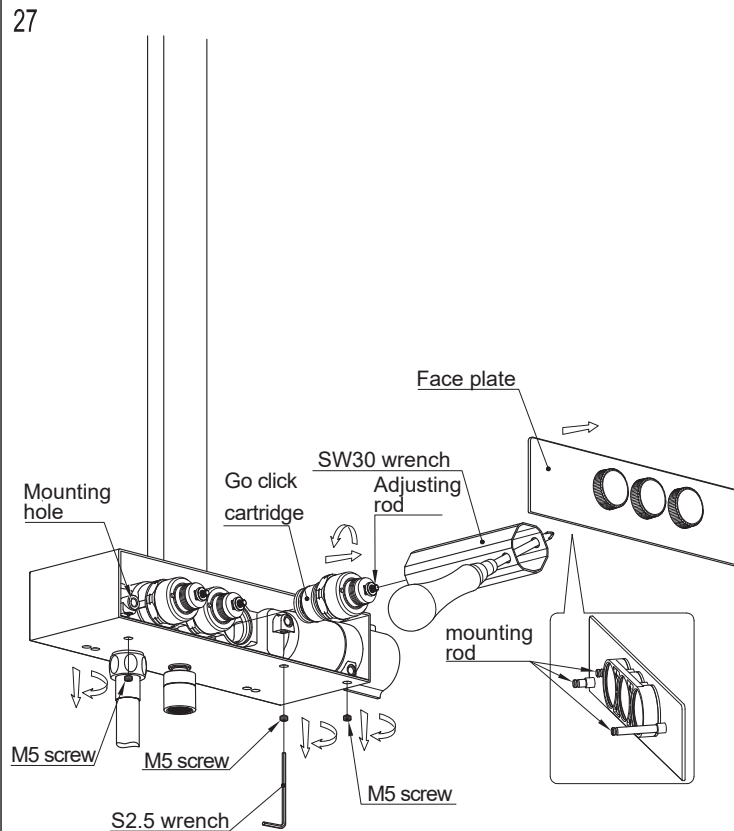

First, turn off the main inlet valve. Then turn on the push buttons and adjust to the minimum volume. Unscrew three M5 screws at the bottom of the mixer body with S2.5 wrench. Take off the faceplate, remove the problematic GoClick cartridge with SW30 wrench. Then assemble them back accordingly after replacement of GoClick cartridge. Make sure the mounting rod on the back of the face plate aligned with the mounting holes on the mixer body, and push buttons aligned with the adjusting rod on the GoClick cartridge.

V. Maintenance (Diagram 24-27):

If water flow from the rainshower head or handshower does not spray evenly, or no water comes out of some nozzles, it is possibly because debris or limescale blocks the nozzles. Please gently squeeze those rubber nozzles with fingers as shown in Diagram 24 and clean up the debris.

If the volume reduces when it comes out of the bottom outlet, it is possibly because debris blocks the aerator. Please remove the aerator with wrench as shown in Diagram 25 and clean the debris, then assemble it back after cleaning.

If the flow rate becomes lessened or temperature control is imprecise after a period of usage, it is possibly because water of poor quality blocks the filter of the thermostatic cartridge. Cleaning method should be taken as followed: First, turn off the main inlet valve. Then pick out the cap by a tool with tip as shown in Diagram 26. Remove the followings one by one : M4 screw, thermostatic handle, stop collar and lock sleeve. Take out the thermostatic cartridge and clean its filter part with clean water and vinegar. Then assemble them back accordingly. Pay attention to keeping the four parts on one line: the slot on the thermostatic cartridge, stop collar, the safety button on the thermostatic handle and the 38°C mark on the cover plate. If the push buttons malfunction, it is possibly because of inappropriate use. Please replace the GoClick cartridge as shown in Diagram 27.