

INSTRUCTION MANUAL

BS02722034

I. Installation Notice

1. Install water pipes in accordance with this manual.
2. Floor drain should be installed on the site.
3. All the components except mixer body should be installed only after the completion of house interior decoration in case paint or other chemicals erode the mixer surface.
4. Run water to clean pipes so as to get rid of mud, sand or other debris blocked in pipes before installation.
5. If the thread does not match well with the water pipe, please find out the reason first; otherwise a forced connection will damage the product.
6. After installation, check all the joints to ensure they are firmly connected. Turn on and off the water repeatedly to ensure there is no leakage around the joints. After that, the product is ready for normal use.
7. Keep the manual to users.

II. Operation Notice

1. The product is used under water pressure 0.05~1.0 MPa, water temperature 4~90°C.
2. Do not hang heavy objects on the mixer.
3. Make sure the faucet is off when no water comes out of it, especially when nobody resides in or during the period of decoration or suspension of water.
4. Regularly clean the surface of faucet to keep it bright. Attention: Do not use inappropriate tools such as sharp brushes, rough sponges, scouring pads or corrosive detergent to clean the faucet. It is not recommended to use the detergent sold in the market, because its formula changes frequently. Please clean the faucet with wet cloth and soapy water after usage. Then rinse the soap off with clean water and dry with a soft cotton cloth.
5. Residues of shampoo, shower gel, hair dye, perfume, shaving water, nail polish, toothpaste and other substances may cause damage to the product. Please carefully rinse residues with clean water after use. Also, do not store detergents and chemicals under the product, such place as vanity cabinet or washbasin; otherwise volatile gases will damage the product.
6. When room temperature falls below 0°C, take necessary measures (keep the product warm, close windows) to prevent the product from frost cracking (especially when windows open for air ventilation while nobody in the house).
7. Turn on the cold water first, then hot water. Adjust the temperature before use to avoid scald.
8. Do not disassemble the product without help from the professionals.

III. Installation Diagram

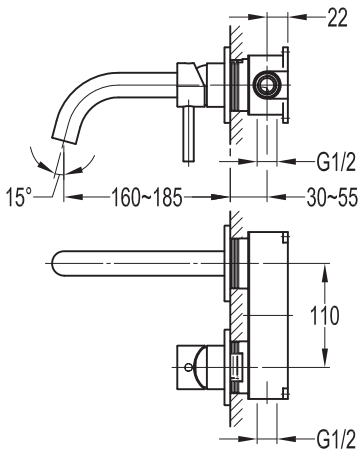

IV. Installation Steps(Fig.1-11): *

The installation diagram is only for reference. The product is subject to the real object.

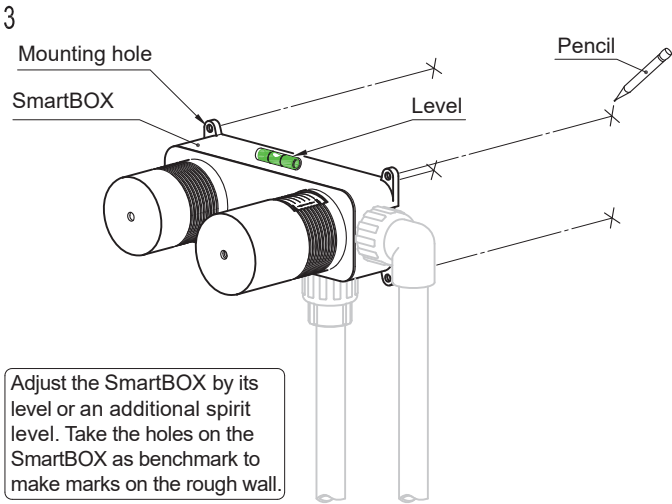
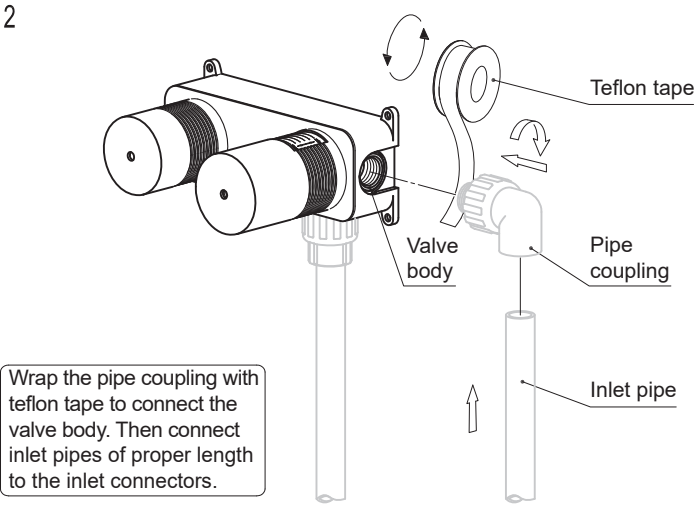
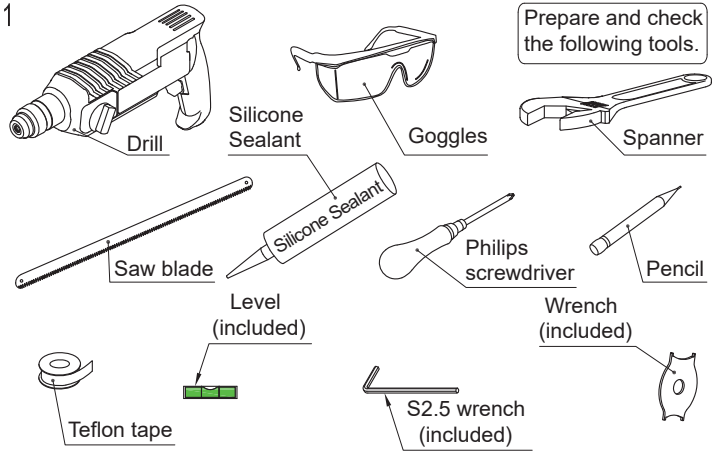

4

Philips screwdriver Self-tapping screw Anchor Ø8

Horizontal level Vertical level

Drill four Ø8 holes at marked positions and insert the anchors. Lightly fix the SmartBOX to the rough wall by self-tapping screws, and tighten it after adjustment with level.

5

Hot water Cold water Feeding pipes

Flow water to get rid of the debris in pipes. Then connect feeding pipes. Please note that inlets must be connected for hot left and cold right. Then run water to perform pressurized test and make sure no leakage.

6

Reference lines for the finished wall

min max

30~55mm

Install ceramic tiles. The distance from pipe center to the finished wall is 30-55mm.

7

Saw blade

Cut the excessive part of the SmartBOX. Please note that the saw blade should only be placed from the edge of the SmartBOX to avoid damage to the product.

8

Silicone Sealant Protection sheath

Apply silicone sealant to the gap between the SmartBOX and the finished wall such as ceramic tiles. Then remove the protection sheath.

9

S2.5 wrench Cap M5 screw Escutcheon Handle

Pass escutcheon through the valve body and place it against the wall. Install the handle and tighten with the M5 screw. Then put back the cap.

10

Escutcheon Spout

Pass escutcheon through the spout. Wrap the spout with teflon tape to connect the valve body. After adjusting the direction of water flow, place the escutcheon against the wall.

11

Double check if the installation is proper upon completion. The diagram shows the product when the handle is turned on.

V. Maintenance

If the flow rate is lessened after a period of usage, it is possibly because water of poor quality blocks the aerator. Cleaning method should be taken as follows:

1. Remove the aerator as shown in the diagram.
2. Rinse dirt off the aerator with clean water.
3. Assemble them back after cleaning.

Gasket Aerator Aerator body Wrench