

INSTRUCTION MANUAL**I. Installation Notice**

1. Floor drain should be installed on the site, and the front end of the product must be equipped with angle valve or nozzle with switch function.
2. All the components except mixer body should be installed only after the completion of house interior decoration. Run water to clean pipes so as to get rid of mud, sand or other debris blocked in pipes before installation. If the thread does not match well with the water pipe, please find out the reason first; otherwise a forced connection will damage the product. After installation, check all the joints to ensure they are firmly connected. Turn on and off the water repeatedly to ensure there is no leakage around the joints. After that, the product is ready for normal use. Hand the manual to users.

II. Operation Notice

1. The product is used under water pressure 0.05~0.5 MPa, water temperature 4~70°C.
2. Make sure the angle valve or nozzle is off when no water comes out of it, especially when nobody resides in or during the period of decoration or suspension of water.
3. Regularly clean the surface of faucet to keep it bright. Attention: Do not use inappropriate tools such as sharp brushes, rough sponges, scouring pads or corrosive detergent to clean the faucet. It is not recommended to use the detergent sold in the market, because its formula changes frequently. Please clean the faucet with wet cloth and soapy water after usage. Then rinse the soap off with clean water and dry with a soft cotton cloth. Do not store detergents and chemicals under the product, such place as vanity cabinet of washbasin; otherwise volatile gases will damage the product.
4. Sensitive parts of the body, such as eyes, must be kept out of water flows from shower head. Children, adults with mental disorders should not be allowed to use the product without supervision, nor should people affected by alcohol or drugs.
5. Adjust the temperature before use to avoid scald. (When adjusting water temperature, the outlet should be prevented from facing the human body.)
6. Do not hang heavy objects on the product and disassemble the product without help from the professionals.

INSTRUCTION MANUAL**I. Installation Notice**

1. Floor drain should be installed on the site, and the front end of the product must be equipped with angle valve or nozzle with switch function.
2. All the components except mixer body should be installed only after the completion of house interior decoration. Run water to clean pipes so as to get rid of mud, sand or other debris blocked in pipes before installation. If the thread does not match well with the water pipe, please find out the reason first; otherwise a forced connection will damage the product. After installation, check all the joints to ensure they are firmly connected. Turn on and off the water repeatedly to ensure there is no leakage around the joints. After that, the product is ready for normal use. Hand the manual to users.

II. Operation Notice

1. The product is used under water pressure 0.05~0.5 MPa, water temperature 4~70°C.
2. Make sure the angle valve or nozzle is off when no water comes out of it, especially when nobody resides in or during the period of decoration or suspension of water.
3. Regularly clean the surface of faucet to keep it bright. Attention: Do not use inappropriate tools such as sharp brushes, rough sponges, scouring pads or corrosive detergent to clean the faucet. It is not recommended to use the detergent sold in the market, because its formula changes frequently. Please clean the faucet with wet cloth and soapy water after usage. Then rinse the soap off with clean water and dry with a soft cotton cloth. Do not store detergents and chemicals under the product, such place as vanity cabinet of washbasin; otherwise volatile gases will damage the product.
4. Sensitive parts of the body, such as eyes, must be kept out of water flows from shower head. Children, adults with mental disorders should not be allowed to use the product without supervision, nor should people affected by alcohol or drugs.
5. Adjust the temperature before use to avoid scald. (When adjusting water temperature, the outlet should be prevented from facing the human body.)
6. Do not hang heavy objects on the product and disassemble the product without help from the professionals.

INSTRUCTION MANUAL**I. Installation Notice**

1. Floor drain should be installed on the site, and the front end of the product must be equipped with angle valve or nozzle with switch function.
2. All the components except mixer body should be installed only after the completion of house interior decoration. Run water to clean pipes so as to get rid of mud, sand or other debris blocked in pipes before installation. If the thread does not match well with the water pipe, please find out the reason first; otherwise a forced connection will damage the product. After installation, check all the joints to ensure they are firmly connected. Turn on and off the water repeatedly to ensure there is no leakage around the joints. After that, the product is ready for normal use. Hand the manual to users.

II. Operation Notice

1. The product is used under water pressure 0.05~0.5 MPa, water temperature 4~70°C.
2. Make sure the angle valve or nozzle is off when no water comes out of it, especially when nobody resides in or during the period of decoration or suspension of water.
3. Regularly clean the surface of faucet to keep it bright. Attention: Do not use inappropriate tools such as sharp brushes, rough sponges, scouring pads or corrosive detergent to clean the faucet. It is not recommended to use the detergent sold in the market, because its formula changes frequently. Please clean the faucet with wet cloth and soapy water after usage. Then rinse the soap off with clean water and dry with a soft cotton cloth. Do not store detergents and chemicals under the product, such place as vanity cabinet of washbasin; otherwise volatile gases will damage the product.
4. Sensitive parts of the body, such as eyes, must be kept out of water flows from shower head. Children, adults with mental disorders should not be allowed to use the product without supervision, nor should people affected by alcohol or drugs.
5. Adjust the temperature before use to avoid scald. (When adjusting water temperature, the outlet should be prevented from facing the human body.)
6. Do not hang heavy objects on the product and disassemble the product without help from the professionals.

INSTRUCTION MANUAL**I. Installation Notice**

1. Floor drain should be installed on the site, and the front end of the product must be equipped with angle valve or nozzle with switch function.
2. All the components except mixer body should be installed only after the completion of house interior decoration. Run water to clean pipes so as to get rid of mud, sand or haother debris blocked in pipes before installation. If the thread does not match well with the water pipe, please find out the reason first; otherwise a forced connection will damage the product. After installation, check all the joints to ensure they are firmly connected. Turn on and off the water repeatedly to ensure there is no leakage around the joints. After that, the product is ready for normal use. Hand the manual to users.

II. Operation Notice

1. The product is used under water pressure 0.05~0.5 MPa, water temperature 4~70°C.
2. Make sure the angle valve or nozzle is off when no water comes out of it, especially when nobody resides in or during the period of decoration or suspension of water.
3. Regularly clean the surface of faucet to keep it bright. Attention: Do not use inappropriate tools such as sharp brushes, rough sponges, scouring pads or corrosive detergent to clean the faucet. It is not recommended to use the detergent sold in the market, because its formula changes frequently. Please clean the faucet with wet cloth and soapy water after usage. Then rinse the soap off with clean water and dry with a soft cotton cloth. Do not store detergents and chemicals under the product, such place as vanity cabinet of washbasin; otherwise volatile gases will damage the product.
4. Sensitive parts of the body, such as eyes, must be kept out of water flows from shower head. Children, adults with mental disorders should not be allowed to use the product without supervision, nor should people affected by alcohol or drugs.
5. Adjust the temperature before use to avoid scald. (When adjusting water temperature, the outlet should be prevented from facing the human body.)
6. Do not hang heavy objects on the product and disassemble the product without help from the professionals.

Installation Steps

BS08142008

1. Tightly connect the hose to the hand shower..
2. When completed, double check if the installation is proper. For this product, water defaults to come out of the diverter. Press the button at the back, water flows from the spray head, and press the button in front to switch.

Cleaning

If water flow from the hand shower is lessened or does not spray evenly after a period of usage, it is possibly because dirt or debris blocks the nozzles. Please take off the hand shower and clean nozzles with a brush and vineagr. Then assemble it back after cleaning. Double check the flow volume. If the flow rate is too low, please remove the spray head and diverter, clean the filter, then put them back accordingly. The method is shown in the diagram.

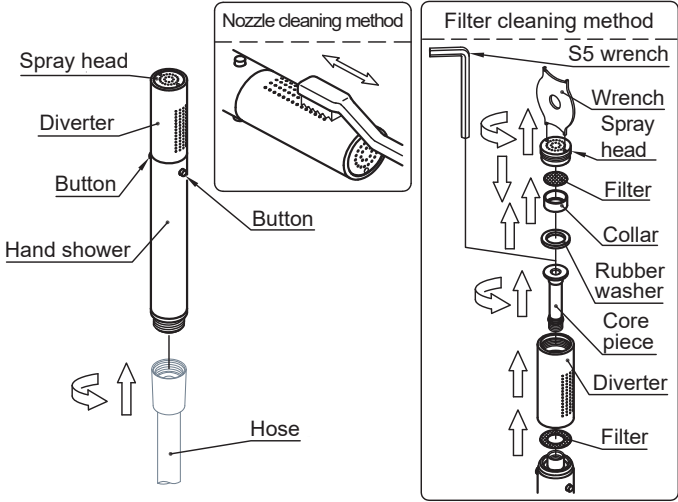

- * The installation diagram is only for reference.
- * The product is subject to the real object.

Installation Steps

BS08142008

1. Tightly connect the hose to the hand shower.
2. When completed, double check if the installation is proper. For this product, water defaults to come out of the diverter. Press the button at the back, water flows from the spray head, and press the button in front to switch.

Cleaning

If water flow from the hand shower is lessened or does not spray evenly after a period of usage, it is possibly because dirt or debris blocks the nozzles. Please take off the hand shower and clean nozzles with a brush and vineagr. Then assemble it back after cleaning. Double check the flow volume. If the flow rate is too low, please remove the spray head and diverter, clean the filter, then put them back accordingly. The method is shown in the diagram.

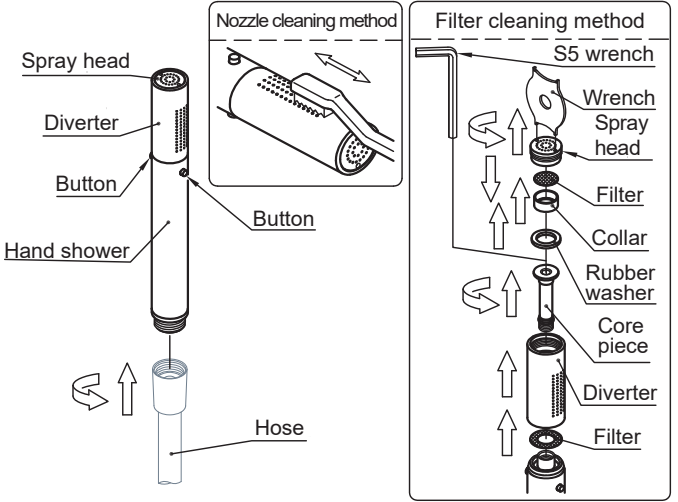

- * The installation diagram is only for reference.
- * The product is subject to the real object.

Installation Steps

BS08142008

1. Tightly connect the hose to the hand shower.
2. When completed, double check if the installation is proper. For this product, water defaults to come out of the diverter. Press the button at the back, water flows from the spray head, and press the button in front to switch.

Cleaning

If water flow from the hand shower is lessened or does not spray evenly after a period of usage, it is possibly because dirt or debris blocks the nozzles. Please take off the hand shower and clean nozzles with a brush and vineagr. Then assemble it back after cleaning. Double check the flow volume. If the flow rate is too low, please remove the spray head and diverter, clean the filter, then put them back accordingly. The method is shown in the diagram.

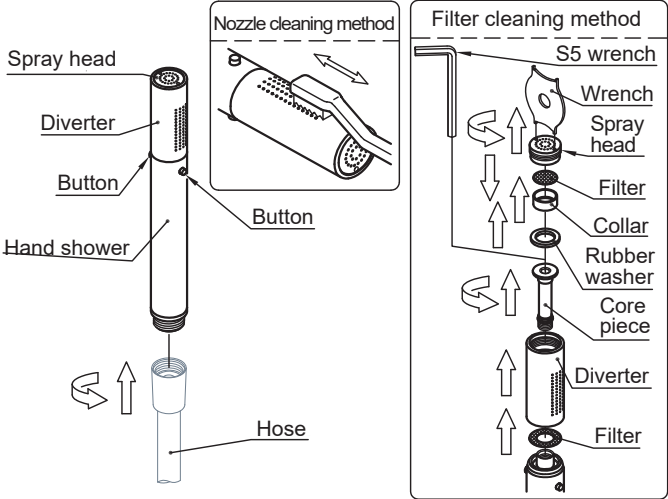

- * The installation diagram is only for reference.
- * The product is subject to the real object.

Installation Steps

BS08142008

1. Tightly connect the hose to the hand shower.
2. When completed, double check if the installation is proper. For this product, water defaults to come out of the diverter. Press the button at the back, water flows from the spray head, and press the button in front to switch.

Cleaning

If water flow from the hand shower is lessened or does not spray evenly after a period of usage, it is possibly because dirt or debris blocks the nozzles. Please take off the hand shower and clean nozzles with a brush and vineagr. Then assemble it back after cleaning. Double check the flow volume. If the flow rate is too low, please remove the spray head and diverter, clean the filter, then put them back accordingly. The method is shown in the diagram.

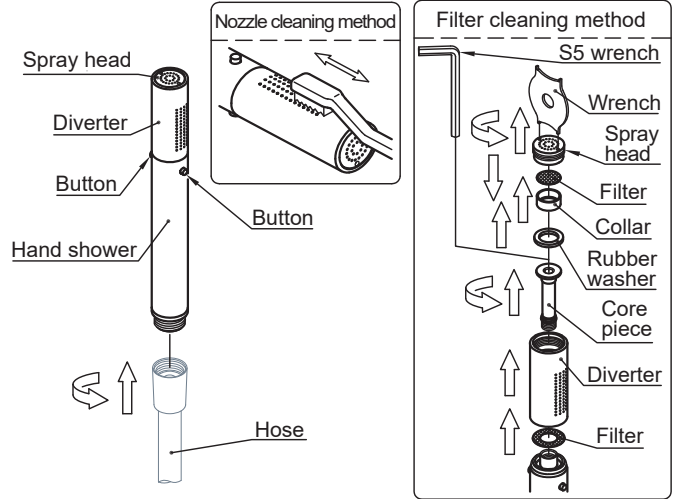

- * The installation diagram is only for reference.
- * The product is subject to the real object.