

INSTRUCTION MANUAL

BS02591710

■ Installation Diagram

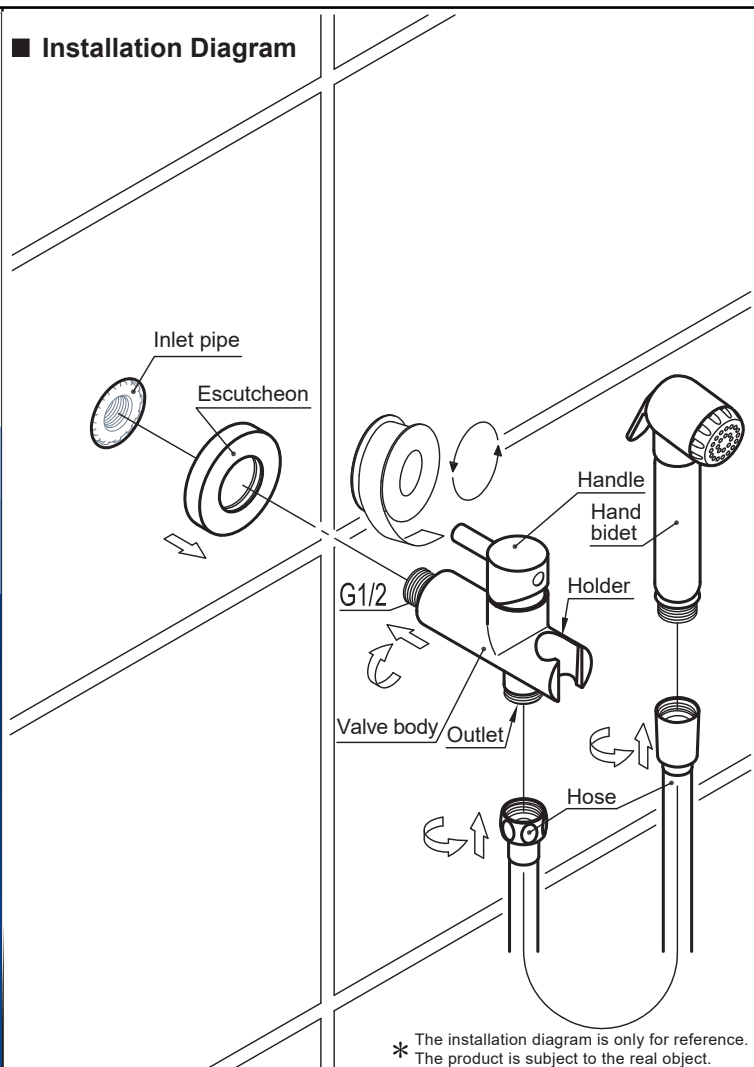

I. Installation Notice

1. Install water pipes in accordance with this manual.
2. Floor drain should be installed on the site.
3. All the components except mixer body should be installed only after the completion of house interior decoration in case paint or other chemicals erode the mixer surface.
4. Run water to clean pipes so as to get rid of mud, sand or other debris blocked in pipes before installation.
5. If the thread does not match well with the water pipe, please find out the reason first; otherwise a forced connection will damage the product.
6. After installation, check all the joints to ensure they are firmly connected. Turn on and off the water repeatedly to ensure there is no leakage around the joints. After that, the product is ready for normal use.
7. Keep the manual to users.

II. Operation Notice

1. The product is used under water pressure 0.05~1.0 MPa, water temperature 4~45°C.
2. Do not hang heavy objects on the mixer.
3. Make sure the faucet is off when no water comes out of it, especially when nobody resides in or during the period of decoration or suspension of water.
4. Regularly clean the surface of faucet to keep it bright. Attention: Do not use inappropriate tools such as sharp brushes, rough sponges, scouring pads or corrosive detergent to clean the faucet. It is not recommended to use the detergent sold in the market, because its formula changes frequently. Please clean the faucet with wet cloth and soapy water after usage. Then rinse the soap off with clean water and dry with a soft cotton cloth.
5. When room temperature falls below 0°C, take necessary measures (keep the product warm, close windows) to prevent the product from frost cracking (especially when windows open for air ventilation while nobody in the house).
6. Do not disassemble the product without help from the professionals.

■ Installation Steps

1. Install water pipes on the wall at a suitable height.
2. Wrap the inlet thread of the valve body with teflon tape and pass the escutcheon through the body. Screw the inlet thread into the inlet pipe and place the escutcheon against the wall. The outlet should face down.
3. Use hose to connect the hand bidet and valve body.
4. Insert the hand bidet into its holder.
5. When completed, double check if the installation is proper.

■ Instructions

Please take off the hand bidet before each use, and turn on the handle on the valve body. After use, please turn off the handle first, then insert the hand bidet into its holder.